

Tailgate

Replacement/Adjustment (Coupe)

1. Remove the quarter window trim and the tailgate trim panel.
2. Remove the rear trim panel, then disconnect the ground cable.
3. Pull the harness out of the body as shown.

NOTE: Before pulling out the wire harness, tie a string to the end of it so you can pull it back in when the tailgate is reinstalled.

4. Hold the tailgate up and remove the nuts from both support strut mounts.
5. Pull down the rear edge of the headliner so it will not interfere with the mount nut removal.
6. Pry the headliner off the tailgate opening flange, remove the hinge mounting bolts and then remove the tailgate.
7. Before tightening the hinge nuts, check the adjustments shown below.

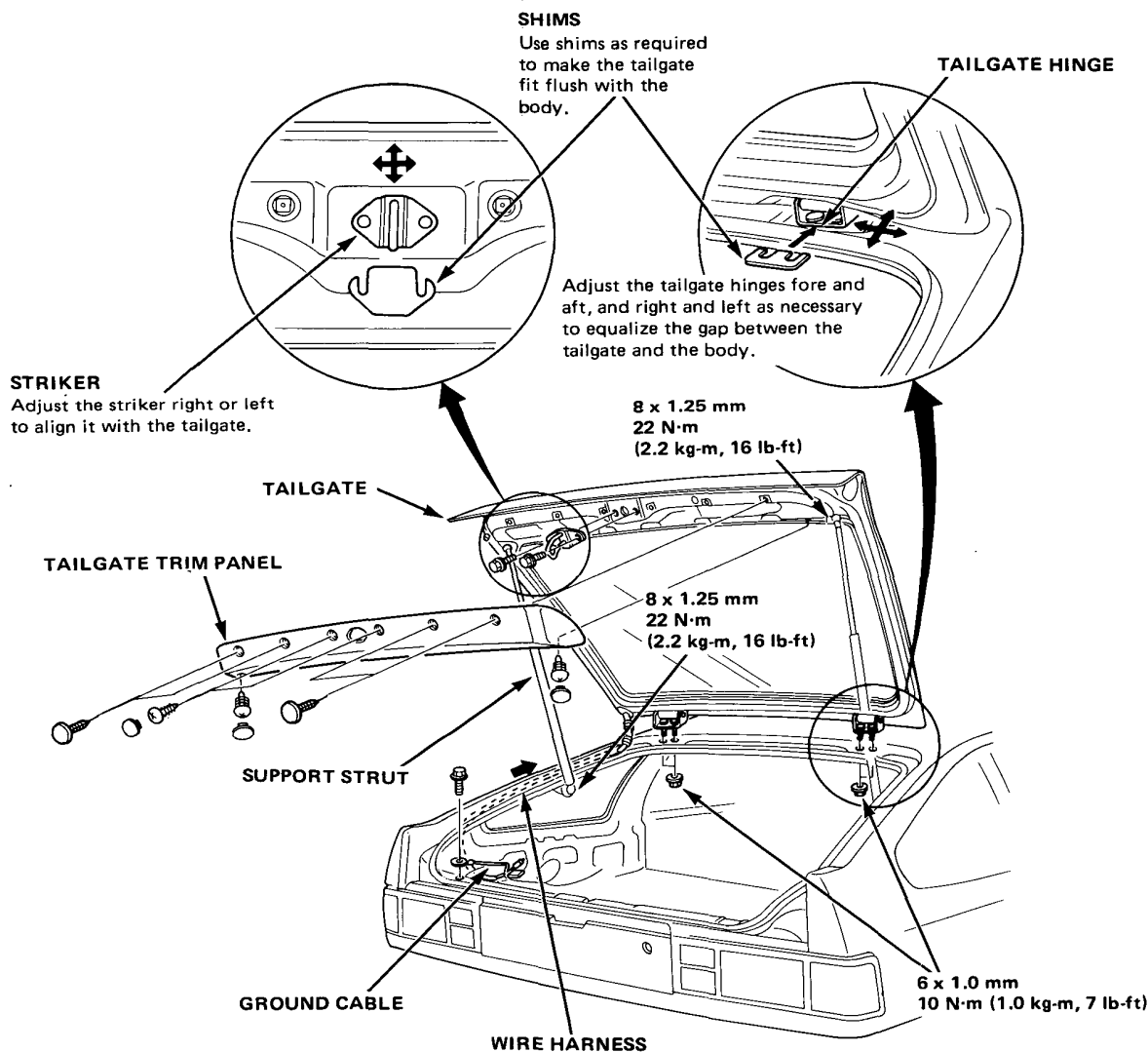



— (2D H/B and 4D H/B)

1. Remove the tailgate trim panel.
2. Disconnect the washer hose.
3. Pull the harness out of the body as shown.

NOTE: Before pulling out the wire harness, tie a string to the end of it so you can pull it back in when the tailgate is reinstalled.

4. Hold the tailgate up and remove the nuts from both support strut mounts.
5. Remove the tailgate mounting bolts and remove the tailgate.

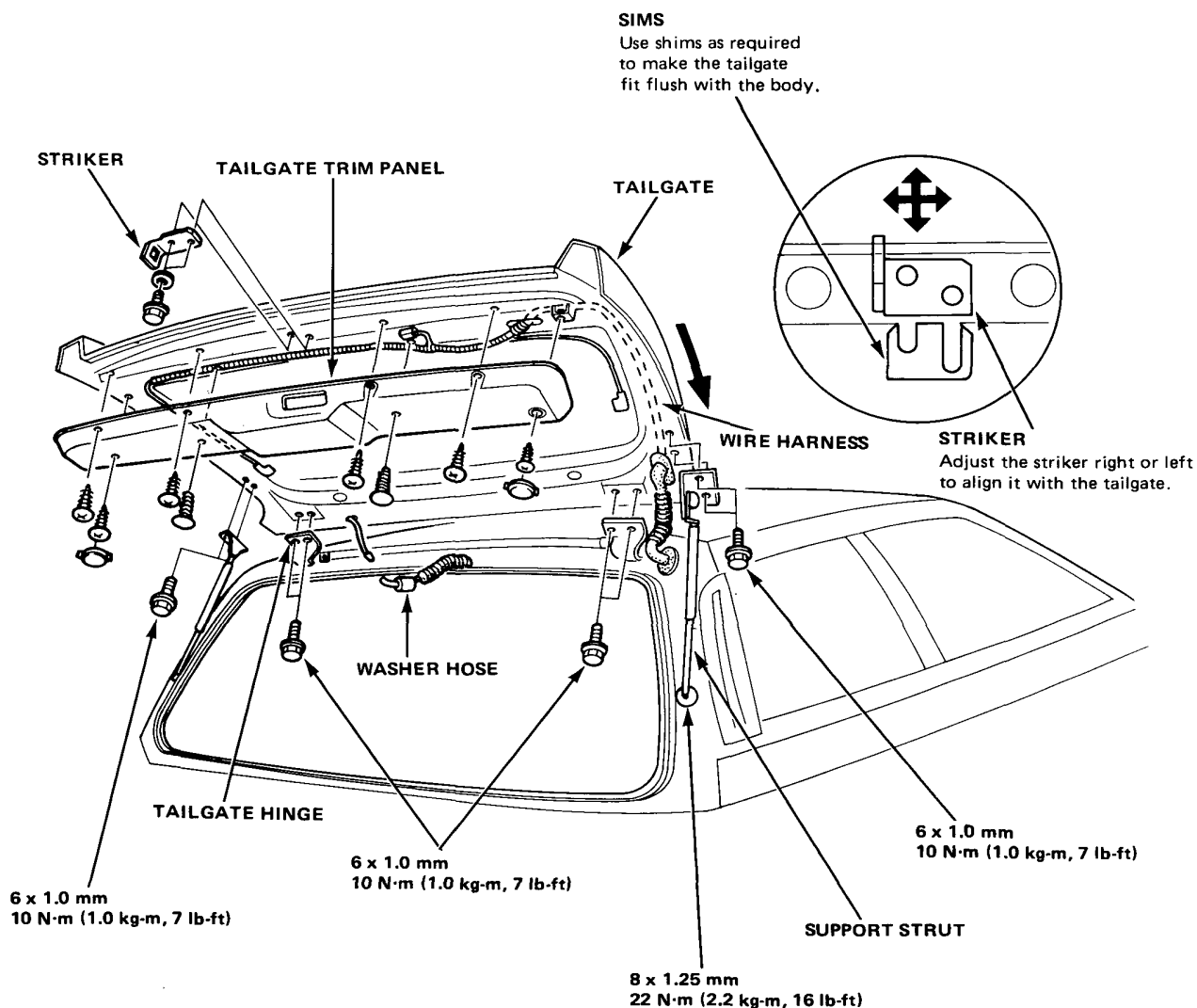

Tailgate

Opener and Latch Replacement

Disassemble in numbered sequence.

